



Facilities Task Force

13 October 2016

Green Bay Area Public Schools
Facilities Master Planning



District Master Plan

Modern Learning Environments

creativity | collaboration | dedication

evolution of learning

A Brief History of School Design

1920's – Industrial Model

- Schools designed to reflect modern thinking
- Standardized thinking and teaching
- Efficient – students trained for a repetitious industrial world
- Not flexible



evolution of learning

A Brief History of School Design

1960's – Experiment in Open Concept

- Movement began in the UK
- Reaction to standardized teaching and learning
- Thought was students learned better outside of the “box”
- Multi-age / multi-instructor organization
- Building design did not synch with teaching and learning



evolution of learning

1990s classroom



evolution of learning

A Brief History of School Design

2000's – Student Centered Learning

- Digitally connected world transforms education
- Students learn anytime, anywhere
- Technology allows for greater individualization
- Spaces become multipurpose and more flexible
- Greater variety of learning environments available



student-centered learning

Various Settings and Context

- Different places for learning
- Self learning vs. organized learning
- Multiple learning styles
- Flipped classroom



student-centered learning

Breakout Areas/Transition Spaces

- Enable team teaching/learning
- Enable project-based learning
- May be used by small or large groups
- Enrichment spaces



student-centered learning

Current Space Configuration

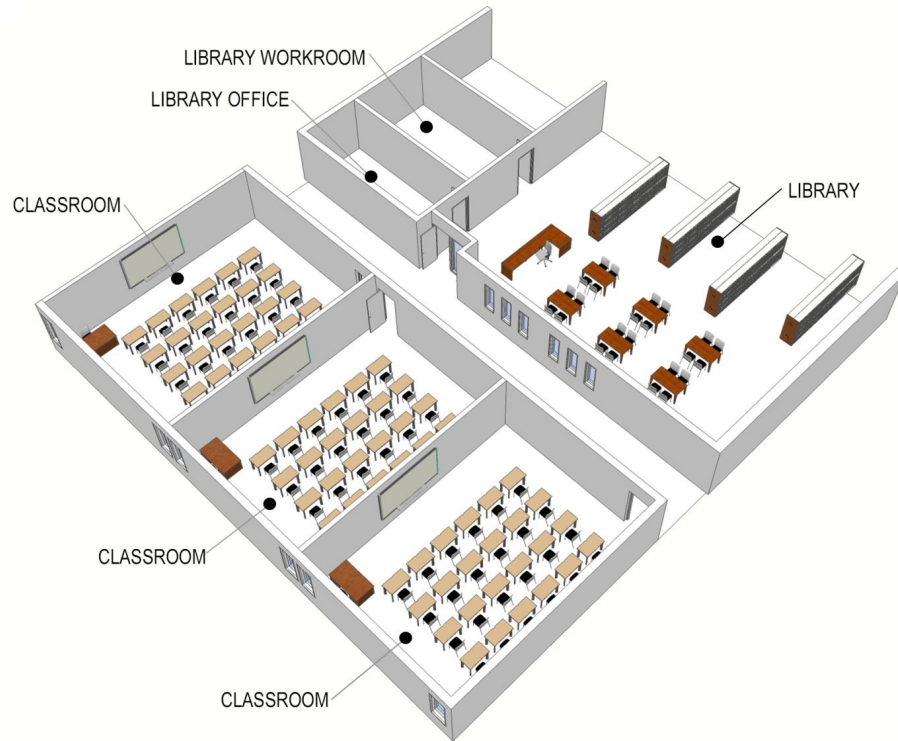

Reconfigured Space

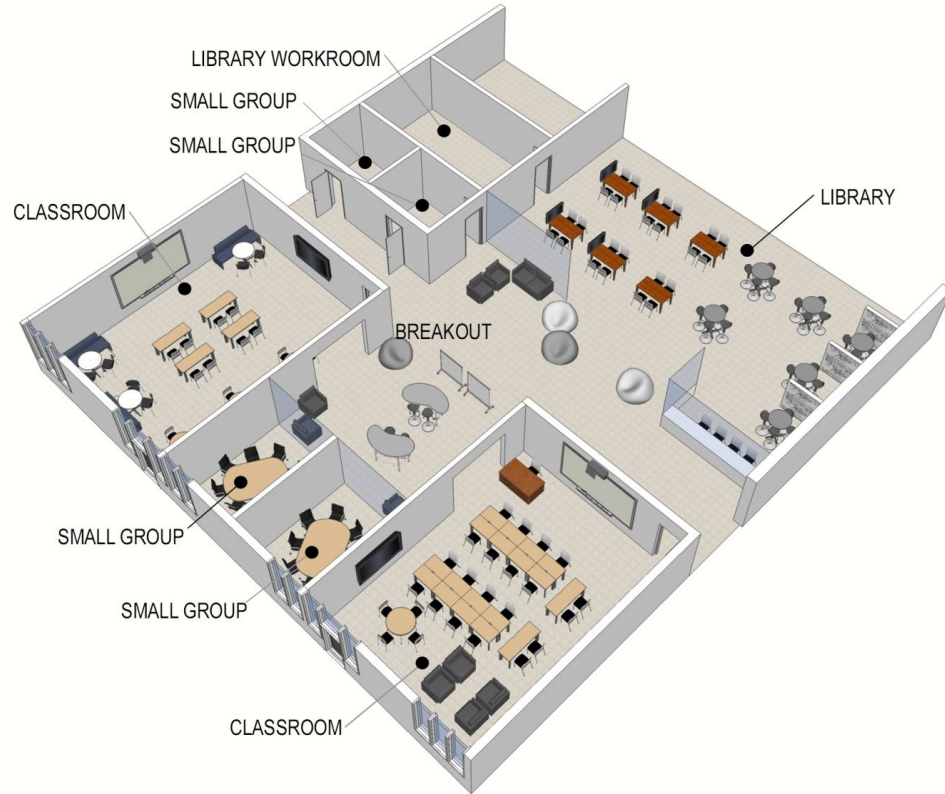

student-centered learning



student-centered learning



student-centered learning

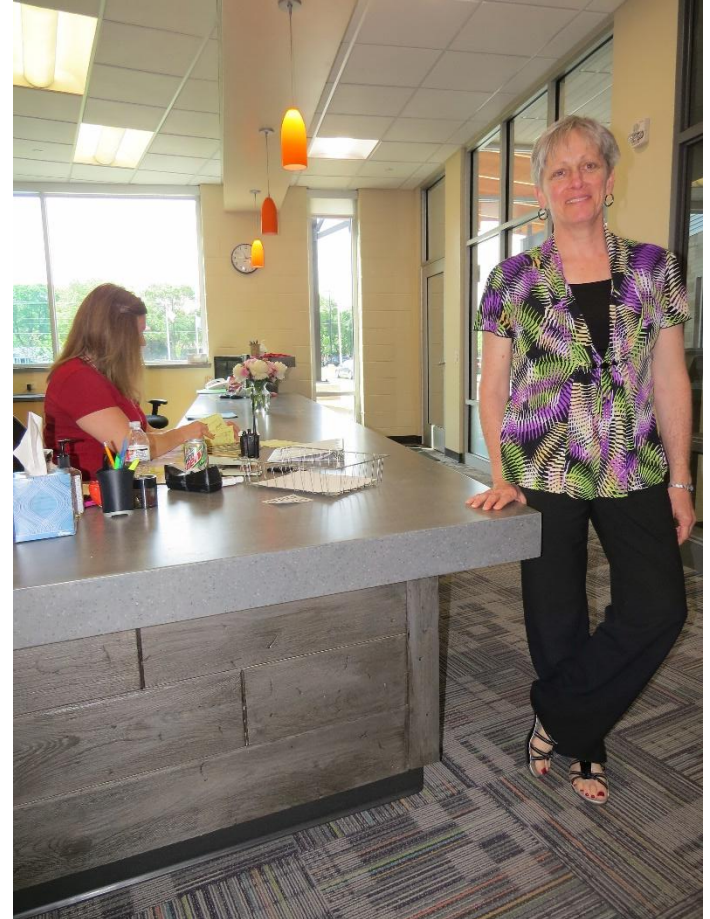

student-centered learning



student-centered learning

